

# ROBOT S6 HD

Heavy Duty Self-Propelled  
Stretch Wrapping Machine

with  **CUBE**  
TECHNOLOGY



**ROBOPAC** 

# Robot S6 with CUBE Technology

Robopac's Robot S6 with CUBE Technology reduces film costs 30%-55% over competitive stretch wrap machines, while improving load containment.

CUBE Technology allows you to deliver **exactly** the right amount of film at **exactly** the right position with **exactly** the right containment force.

**Variable pre-stretch** ensures the best film economy for any load. It also allows you to get the highest containment and best film economy from any stretch film. Robopac's Variable Pre-Stretch Technology delivers 30% to 55% film savings.

**ProActive corner compensation** combines the latest in load cell and encoder technology giving you the ability to wrap any load securely without crushing the corners of your load,

while increasing containment on the flat sides.

**Multi-level containment force** settings on the control panel deliver optimal containment force at each level and enable delivery of the highest pre-stretch levels.

**Strategic film placement** allows you to place the film exactly where it has the most impact on load containment.

**Six wrapping menus** allow you to pre-program

wrap parameters to effectively wrap varied loads with minimal operator interaction.

The portability of the Robot S6 can deliver **20+% productivity improvement** in order picked warehouse applications with minimal impact to your current processes.

**CUBE Technology**  
Variable pre-stretch  
Pro-Active corner compensation  
Multi-level containment force  
Strategic film placement

## innovative features



### Robopac's Patented Power Variable Pre-Stretch Roll Carriage

Robopac's innovative and patented S-winding pattern and dual motor pre-stretch system give you the ability to pre-stretch film from 100% up to 400% using two independent, variable AC motors. Both the pre-stretch and containment force are adjustable via the operator control panel. Robopac's patented high-performance S-Wrap Pattern (with Quick Load System) and load cell compensation and containment force device give you total film control.

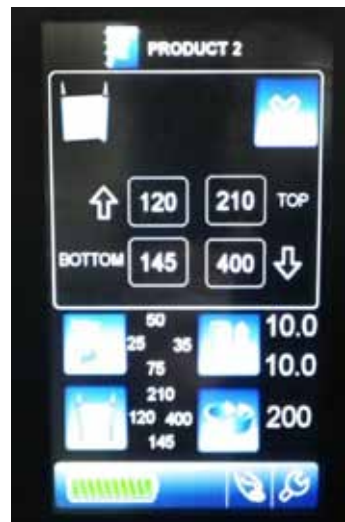

### Intuitive User Interface

Color touch screen panel with intuitive software gives the operator more control while simplifying the machine operation.

Six wrapping menus allow you to easily select the best wrapping pattern for your loads and consistently repeat the pattern time after time.

# heavy duty upgrades

## Flexible Bumper with Reinforced Connection

Redesigned bumper is flexible and recovers from collisions with stationary objects, forklifts or hand trucks. Additional bolts connection the bumper to the Robot ensure bumper remains attached even in a high-impact collision.



## Roll Carriage Cover

Thicker and stronger and now mounted to the frame with 3 screws (previously 2 screws). Additional warning label on top to prevent placement of heavy items that could damage the cover.



## Steering Arm

New buttons feature sealed wires. Connector allows you to remove the entire assembly for transport. Steering arm has been reinforced with internal plate and hexagonal head screws for top locking anti-slip grip.



## Tracing Wheel

The tracing arm wheel, with new hexagonal screws underneath, allows the brake system to block. Reinforced tracing wheel can be easily inverted to allow better contouring of the load.



## Gearbox

The new gearbox allows you to fix the wheel with top locking anti-slip grip (all-metal self-locking nut and washer Nord-Lock). A nylon ring was added to the gearbox to protect the oil seal.



## Front Wheel Support

New front wheel steering support reinforces the steering arm in the down position, when manually transporting the Robot.

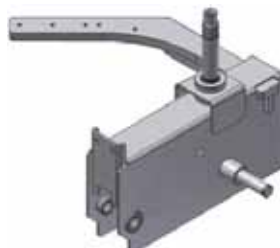

## Machine Frame

Machine frame has been modified to allow additional space for wiring.



# standard features

- Variable pre-stretch allows you to adjust machine to get the best containment and the best economy from every film on every load.
- Encoders on the roll carriage's dual motors provide complete control of pre-stretch and containment force.
- Roll carriage features an automatic stopping device to prevent accidental falls.
- Emergency stop bumper with dual sensors detect the slightest resistance and automatically ends cycle on contact.
- "QLS" (Quick Load System) allows for safe, quick and easy film loading.
- High-frequency battery charger for 110V to 240V. Works with both acid and gel batteries.
- Unit can be relocated manually, without power, using the idle wheel feature.
- Manual towing controls provide maximum comfort and allow for precise positioning of the robot.
- Guide wheel height can be adjusted easily, without the use of tools.

# specifications

| Technical Features                 |   |
|------------------------------------|---|
| <b>Machine</b>                     | S6 HD   |
| <b>Performance</b>                 |   |
| Production Speed                   | Up to 30 LPH  |
| Production Temperature Range       | 15F-104F  |
| <b>Load Handling</b>               |   |
| Load Size                          | Unlimited diameter  |
| Maximum Load Diagonal              | Unlimited   |
| Maximum Load Height                | 110"  |
| Maximum Load Weight                | Unlimited   |
| <b>Film</b>                        |   |
| Film Delivery System               | Power Variable Stretch (PVS) with Pro-active CUBE Technology    |
| Standard Pre-Stretch               | Variable to 400%  |
| Wrapping Force                     | Load Cell   |
| Standard Film Width                | 20"   |
| Automatic Film Cut                 | Standard  |
| Automatic Film Break Alarm         | Standard  |
| Load Height Detection              | Infrared Photocell<br>Detects dark, clear and or shiny products |
| <b>Safety Features</b>             |   |
| Emergency Bumper with Dual Sensors | Standard  |
| CE Compliant                       | Yes   |
| Anti-Fall Device                   | Standard  |
| <b>Service Requirements</b>        |   |
| Charger Requirement                | 110VAC / 1ph/60Hz (+/-10%)                                      |
| NEMA 12 Enclosure                  | Standard  |
| <b>Warranty</b>                    | 1 Year  |

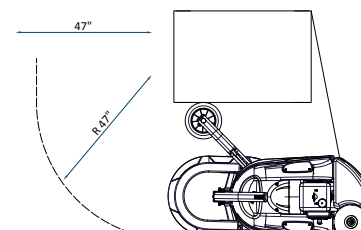
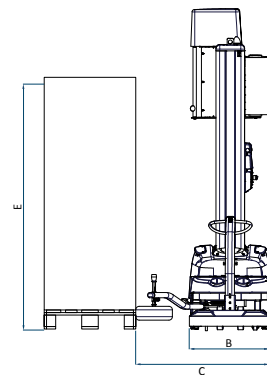
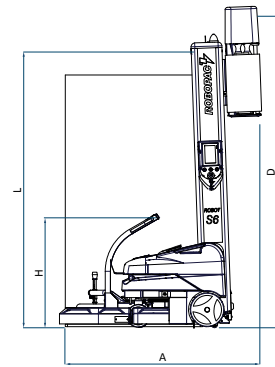

| Machine Dimensions | Wrapping Height = 86" | Wrapping Height = 94" | Wrapping Height = 110" | Wrapping Height = 122" |
|--------------------|-----------------------|-----------------------|------------------------|------------------------|
| A                  | 72"                   | 72"                   | 72"                    | 72"                    |
| B                  | 28.5"                 | 28.5"                 | 28.5"                  | 28.5"                  |
| C                  | 46.5"                 | 46.5"                 | 46.5"                  | 46.5"                  |
| H                  | 39"                   | 39"                   | 39"                    | 39"                    |
| D                  | 110"                  | 118"                  | 134"                   | 142"                   |
| L                  | 100.5"                | 108.5"                | 124.25"                | 132"                   |